

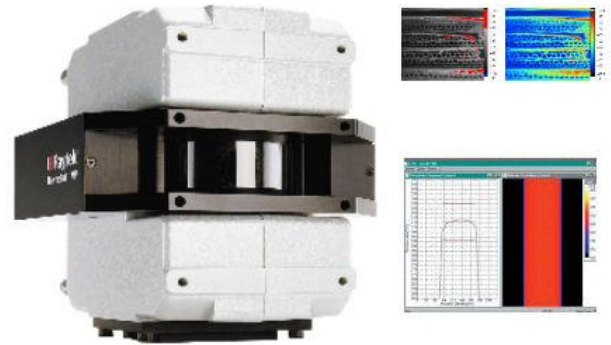

BENEFITS

- Sampling speeds of up to 150 lines per second
- Measurement points along a line: 1024 measurement points +at 36 sampled lines per second; 512 measurement points at 75 scanned lines per second; 256 measurement points at 150 scanned lines per second
- High system reliability scanner engine with MTBF 40,000h
- 3 user programmable 4-20mA current outputs
- High integration through Profibus, CP340, CP341, OPC
- RS485 interface for transmission paths up to 1000m
- Ethernet interface TCP/IP 100Mbps
- Robust IP65 housing and optional protective housing
- Effective air purge to keep the measurement window clean
- Integrated water cooling for ambient temperatures up to 180 ° C



DESCRIPTION / APPLICATION EXAMPLES

IR **Adhesive-Scan** is a modular system for reliable, continuous gluing control in the corrugated board industry. Adjustable monitoring sectors within the profile measurement allow individual temperature evaluation and alarming of specific areas. Thus, it ensures an optimized control of the preheater and the glue application units. A monitoring system computer is capable of managing up to 8 sensor units. The provision of a variety of industry standard interfaces allows for easy integration of the system into existing process controls or control systems. Thus, trend functions and alarm value processing, as well as control tasks in the usual PLC / PLS environment can be realized. By using one or more RAYTEK MP150 IR-Line scanners with an opening angle of 90 °, even large web widths can be detected and evaluated nationwide in confined spaces. The self-contained multitasking sensor units can visualize measured values on a built-in IPC panel after one-time pre-configuration without further user input, while the sector results for the necessary control tasks are transferred directly to the system control.

MEASUREMENT SPECIFICATIONS

GENERAL PARAMETERS

Line Frequency [Hz]	150, 125, 108, 75, 48, 36, 20
System response time	7ms
Scan angle	90° / 45°
Emissivity	0,1 ... 1,0 digitally adjustable
Measuring points	256 ... 1024 measuring points per line (adjustable)
	800 lines per image (adjustable)
Signal processing	Max-, Min-, Mean, Max- minus Mean value, Measuring points above alarm value, gradient, Standard deviation (adjustable per sector)
Analogue outputs	0/4 ... 20mA (optional)
Digital outputs	Relay or solid state relay (optional)
Alarm outputs	4 Relays (changer)
	Temp. Alarm, Watchdog, System error
PLC coupling	OPC, Profibus, CP340, CP341
Power supply	230VAC
Scope of delivery	Sensor unit, Interface, System computer incl. Software, Monitor, input devices, documentation

Protection class	IP65 (IEC 529)
Ambient temperature	
without Water cooling	0 ... 50°C
with Water cooling	max. 180°C
internal device temperature	0 ... 60°C
Storage temperature	-25 ... 65°C
Relative humidity	10 ... 90%, non-condensing
Shock	IEC 68-2-29, 3 axles, 1000 shocks, in operation: 5G, out of service: 25G
Vibration	IEC 68-2-6, 3 axles, 10 – 150Hz, in operation: 0,5G, out of service: 2G
	MTBF: 40.000hours
mechanical scanning system	
Water cooling,	
air purge	Standard
max. Water pressure	5 bar
max. Air pressure	3 bar
Dimensions	
(Sensor unit)	450 x 450 x 450mm
Weight (Sensor unit)	approx.. 15 kg, plus mounting



INTERFACE / SECTOR MONITORING

In the detection range of the sensor units, any number of independent sectors including numerous mathematical functions can be defined. The sectors related measurement results or their links with each other can be individually routed via defined interfaces to a PLS and / or evaluate locally in this system. System logs provide information about events that have occurred and document them with a time stamp. A client installation allows other computers in the network to access stored data and to document this thermally and temporally.

ACCESSORIES

SEL-IMG-RMB
SEL-IMG-FWCP
SEL-IMG-FWPBDP
SEL-IMG-APCOMP

Stable ceiling mount
Profibus S7 connection
CP340 / 341 S7 connection
Gas ring compressor for purging
air supply

SEL-IMG-PBDPLWL
SEL-IMG-485LWL
SEL-IMG-AO
SEL-IMG-DOOC
SEL-IMG-DOR
SEL-IMG-MP150TILT

Profibus DP / fiber optic Transmitter
RS485 / fiber optic Transmitter
4 analogue outputs 0(4) ... 20mA
16 digital outputs (Open Collector)
7 digital outputs (relay / NO)
Further sensor unit

Options
SEL-TMP150CERT

ISO calibration certificate based
on NIST/DKD certified probes

SCANNER WITH CONNECTIVITY

Water cooling 6mm
Inner ø

Air purge
ISO 228G1/8"
4mm Inner ø

Water cooling
6mm Inner ø

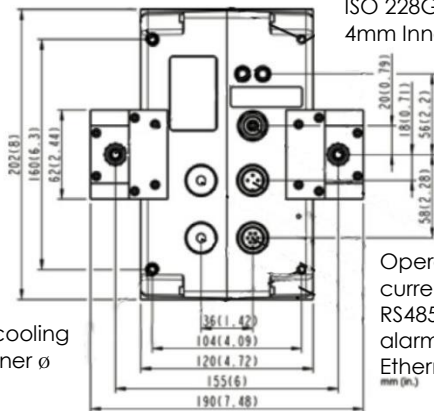

Operating voltage
current outputs
RS485 interface
alarm, trigger, laser,
Ethernet
mm (in.)

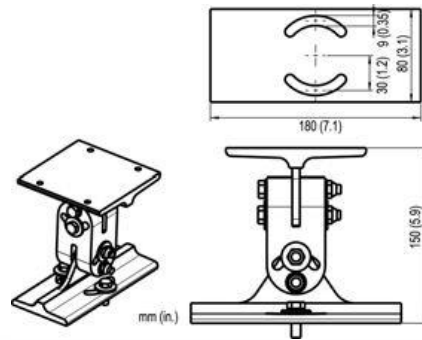
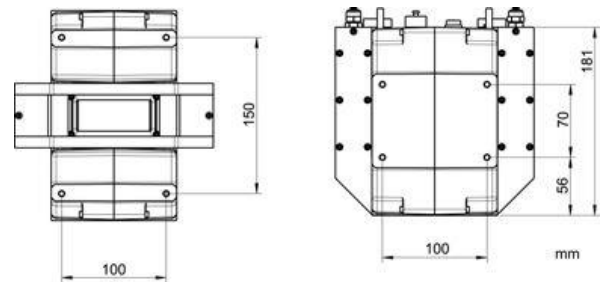

LAYOUT EXAMPLE

